



BUILD BETTER. BUILD STRONGER. BUILD TO LAST.



# 2025 POST-FRAME PRODUCTS

v04-03-25

# PERMA-COLUMN® 2025 POST-FRAME PRODUCTS



- Precast Concrete Columns ..... 3
- Precast Concrete Columns – for Glu Lam ..... 4
- Precast Skirt Boards..... 5
- FootingPad® Composite Footings ..... 6
- Sturdi-Wall® Anchor Brackets ..... 7
- Sturdi-Wall® Anchor Brackets – for Glu Lam ..... 8
- Sturdi-Wall® Plus Anchor Brackets ..... 9
- Sturdi-Wall® Plus Anchor Brackets – for Glu Lam ..... 10
- Hardware ..... 11
- Hardware Kits ..... 12
- Drill Set Hardware Kits ..... 13
- Uplift Anchor Kits ..... 14
- Column Extenders..... 15

# PRECAST CONCRETE COLUMNS

ICC-ES certified Perma-Column® precast concrete columns elevate wood out of the ground, ensuring your building's foundation will never rot. They combine the economy of post-frame construction with the durability of a concrete foundation. They are constructed of 100% American-made 1/4" steel finished with a tough powder coat, 1/2" and 5/8" grade 60 rebar, and 10,000 psi concrete.

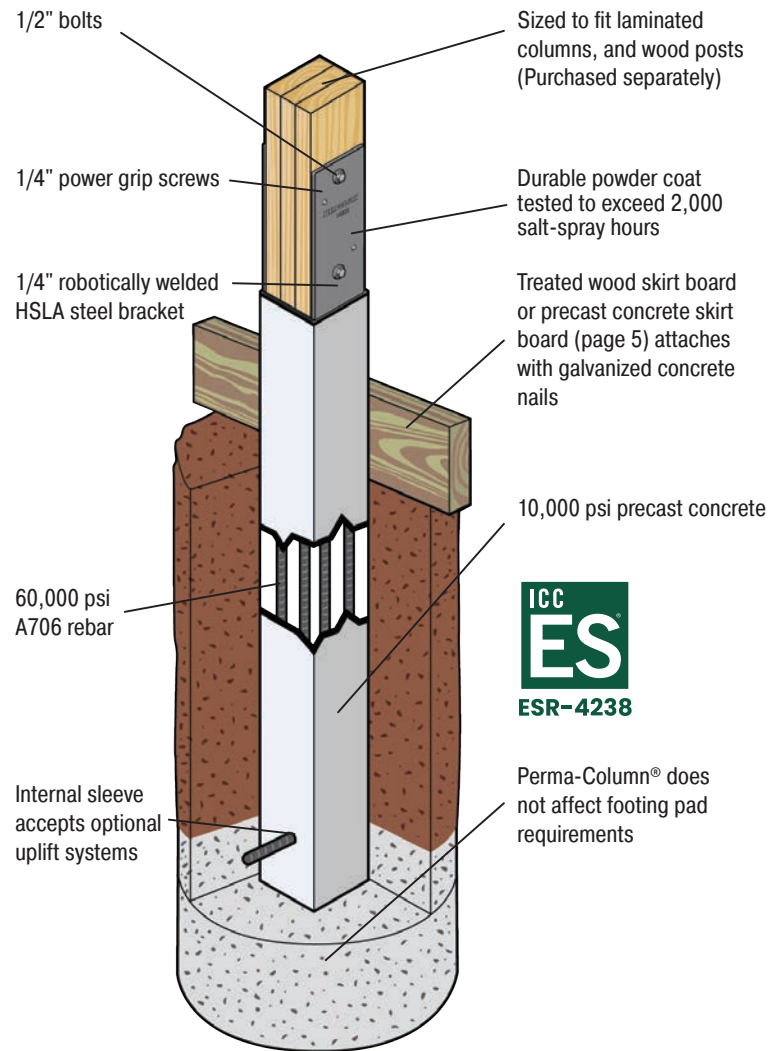

Model ID	Type	Bracket height	Description	Weight (lbs.)
PC4600	4" x 6"	13"	3-5/8" pocket fits 4" x 6" post	135
PC6300	3-Ply 2" x 6"	13"	4-5/8" pocket fits 3-Ply 6" laminated column	165
PC6400	4-Ply 2" x 6"	18"	6-1/8" pocket fits 4-Ply 6" laminated column	215
PC6600	6" x 6"	13"	5-5/8" pocket fits 6" x 6" post	196
PC8300	3-Ply 2" x 8"	18"	4-5/8" pocket fits 3-Ply 8" laminated column	235
PC8400	4-Ply 2" x 8"	18"	6-1/8" pocket fits 4-Ply 8" laminated column	290
PC8500	5-Ply 2" x 8"	18"	7-5/8" pocket fits 5-Ply 8" laminated column	345

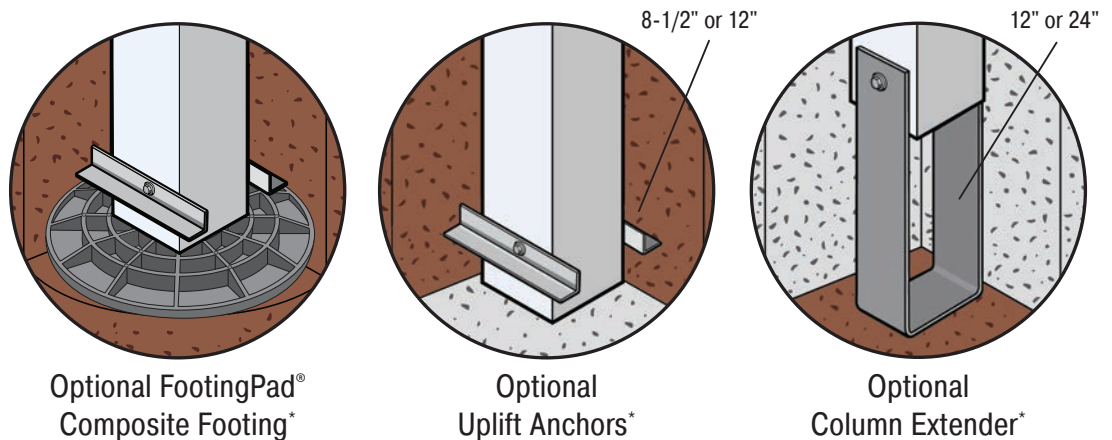

\*Uplift kits and hardware sold separately. Don't forget concrete nails (Item HW28) to attach the treated base board.

# PRECAST CONCRETE COLUMNS

ICC-ES certified Perma-Column® precast concrete columns elevate wood out of the ground, ensuring your building's foundation will never rot. They combine the economy of post-frame construction with the durability of a concrete foundation. They are constructed of 100% American-made 1/4" steel finished with a tough powder coat, 1/2" and 5/8" grade 60 rebar, and 10,000 psi concrete.

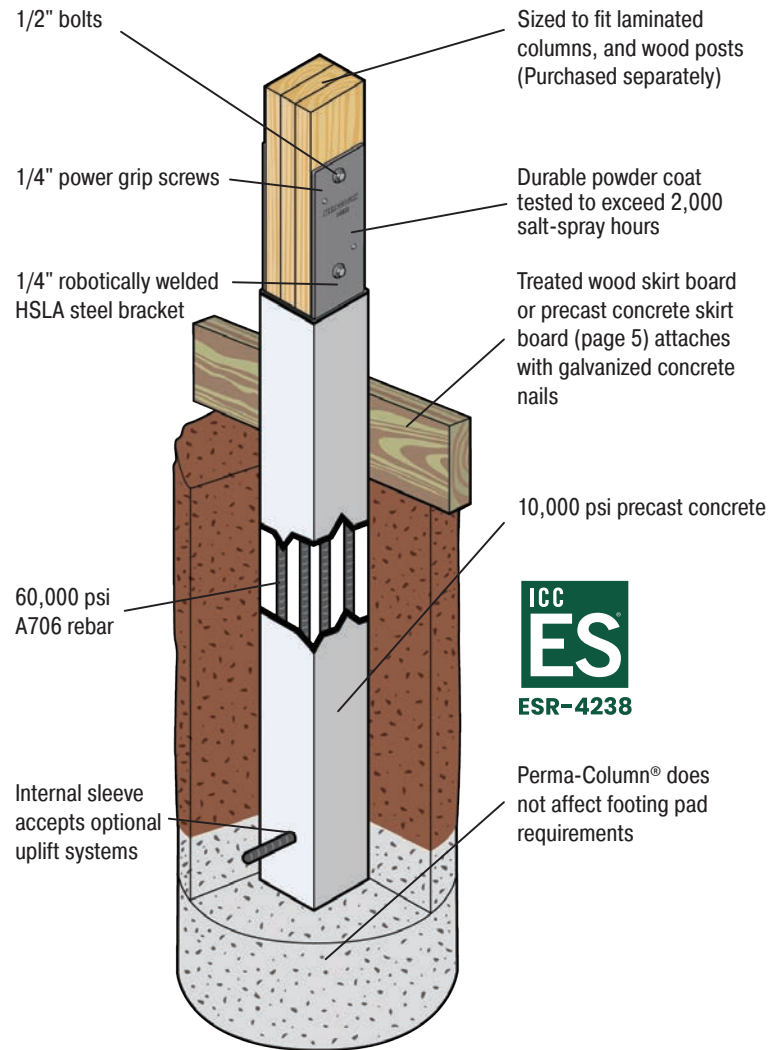

Model ID	Type	Bracket height	Description	Weight (lbs.)
<b>PC6300GL</b>	3-Ply 2" x 6"	13"	4-3/16" pocket fits 3-Ply 6" laminated column	165
<b>PC6400GL</b>	4-Ply 2" x 6"	18"	5-9/16" pocket fits 4-Ply 6" laminated column	215
<b>PC8300GL</b>	3-Ply 2" x 8"	18"	4-3/16" pocket fits 3-Ply 8" laminated column	235
<b>PC8400GL</b>	4-Ply 2" x 8"	18"	5-9/16" pocket fits 4-Ply 8" laminated column	290
<b>PC8500GL</b>	5-Ply 2" x 8"	18"	6-15/16" pocket fits 5-Ply 8" laminated column	345

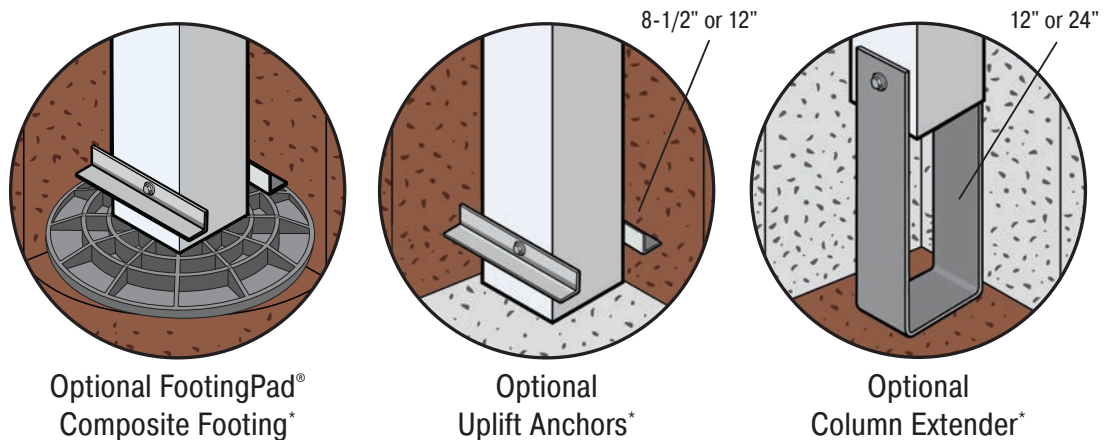

\*Uplift kits and hardware sold separately. Don't forget concrete nails (Item HW28) to attach the treated base board.



## PRECAST SKIRT BOARDS

Eliminate all wood contact with soil in post-frame construction. Patented precast skirt boards strengthen post-frame foundations and lengthen service life. Hybrid concrete-wood design prevents rot or warp and makes them stronger, stiffer, and straighter than standard treated wood skirt boards. Installed with Perma-Column® precast concrete columns, precast skirt boards create a complete permanent foundation solution guaranteed to last generations.



Ultra-high-strength design  
8,000+ PSI precast concrete  
MCA treated 2-by-4 wood  
Basalt composite rebar

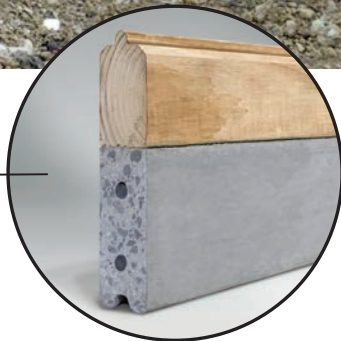

### SKIRT BOARD BOARDS

Item #	Description	Weight (lbs.)	Pallet Qty (count)
<b>SKB080</b>	1-1/2" x 7-1/2" x 8 1/2' tongue-and-groove skirt board	56	25
<b>SKB100</b>	1-1/2" x 7-1/2" x 10' tongue-and-groove skirt board	74	25
<b>SKBW80</b>	8' walk-door stiffener	45	25

### HARDWARE

Item #	Description	Weight (lbs.)	Box Qty (count)
<b>PC15SB</b>	G185 galvanized skirt board bracket	0.5	100
<b>HW26</b>	3/16" x 1-1/8" galvanized concrete nail	0.013	1000

### SKIRT BOARD PROFILE

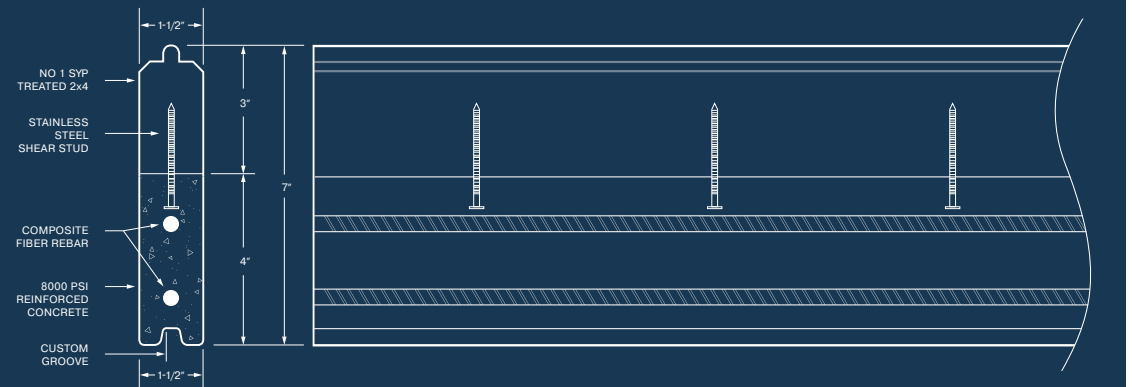

## FOOTINGPAD® COMPOSITE FOOTINGS

Lightweight and easy to handle on the job site, FootingPad® composite footings provide the equivalent strength and durability of concrete footers — at a fraction of the time, cost, and weight. Certified code compliant by the ICC-ES, FootingPad® composite footings are engineered to meet or exceed the load capacity of concrete.



Model ID	Type	Description	Weight (lbs.)
FP-10	10"	10" diameter composite footing pad	1.2
FP-12	12"	12" diameter composite footing pad	2.5
FP-16	16"	16" diameter composite footing pad	4.7
FP-20	20"	20" diameter composite footing pad	8.5
FP-24	24"	24" diameter composite footing pad	14

### FOOTINGPAD® COMPOSITE FOOTING

FootingPad® composite footings use a proprietary fiber-reinforced polymer composite that is impervious to damaging elements such as water, insects, and oxygen, providing exceptional strength and durability.

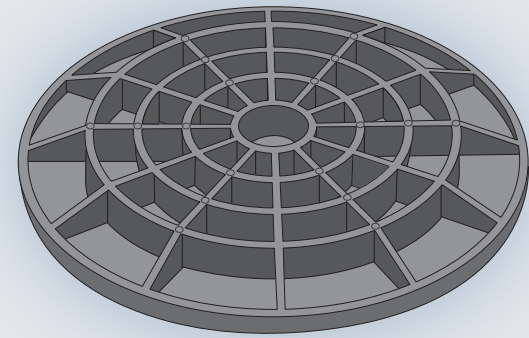

# STURDI-WALL®

The Sturdi-Wall® system allows for post-frame construction on traditional concrete foundations. ICC-ES certified Sturdi-Wall® anchor brackets are constructed of 100% American-made 1/4" steel, robotically welded, and finished with a tough powder coat. Install these engineered wall brackets with a masonry drill bit and concrete anchors.\*



## DRILL-SET ANCHOR BRACKETS

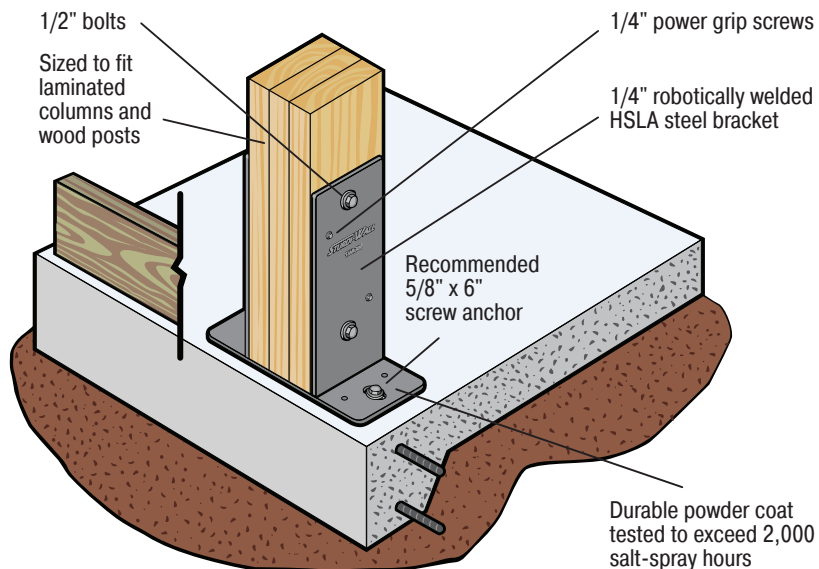

Model ID	Type	Bracket height	Description	Weight (lbs.)
SW46	4" x 6"	13"	3-5/8" pocket fits 4" x 6" post	13
SW60	6" universal	13"	Used in pairs to fit odd-sized columns, or alone at corners and doors	6
SW63	3-Ply 6"	13"	4-5/8" pocket fits 3-Ply 6" laminated column	13
SW64	4-Ply 6"	13"	6-1/8" pocket fits 4-Ply 6" laminated column	13
SW66	6" x 6"	13"	5-5/8" pocket fits 6" x 6" post	13
SW80	8" universal	18"	Used in pairs to fit odd-sized columns, or alone at corners and doors	10
SW83	3-Ply 8"	18"	4-5/8" pocket fits 3-Ply 8" laminated column	24
SW84	4-Ply 8"	18"	6-1/8" pocket fits 4-Ply 8" laminated column	24
SW85	5-Ply 8"	18"	7-5/8" pocket fits 5-Ply 8" laminated column or 8" x 8" post	26
SW88	8" x 8"	18"	8-1/8" pocket fits 8" x 8" architectural post	27

\*Hardware sold separately.



## STURDI-WALL®

The Sturdi-Wall® system allows for post-frame construction on traditional concrete foundations. ICC-ES certified Sturdi-Wall® anchor brackets are constructed of 100% American-made 1/4" steel, robotically welded, and finished with a tough powder coat. Install these engineered wall brackets with a masonry drill bit and concrete anchors.\*



### DRILL-SET ANCHOR BRACKETS

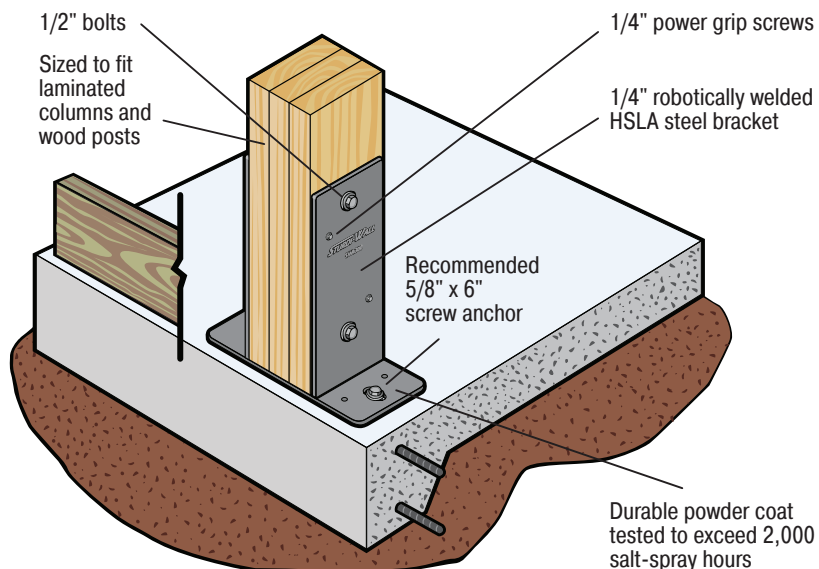

Model ID	Type	Bracket height	Description	Weight (lbs.)
<b>SW60</b>	6" universal	13"	Used in pairs to fit odd-sized columns, or alone at corners and doors	6
<b>SW63GL</b>	3-Ply 6"	13"	4-3/16" pocket fits 3-Ply 6" laminated column	13
<b>SW64GL</b>	4-Ply 6"	13"	5-9/16" pocket fits 4-Ply 6" laminated column	13
<b>SW80</b>	8" universal	18"	Used in pairs to fit odd-sized columns, or alone at corners and doors	10
<b>SW83GL</b>	3-Ply 8"	18"	4-3/16" pocket fits 3-Ply 8" laminated column	24
<b>SW84GL</b>	4-Ply 8"	18"	5-9/16" pocket fits 4-Ply 8" laminated column	24
<b>SW85GL</b>	5-Ply 8"	18"	6-15/16" pocket fits 5-Ply 8" laminated column or 8" x 8" post	26

\*Hardware sold separately.

**STURDI-WALL®**  
BY PERMA-COLUMN



# STURDI-WALL® PLUS

The Sturdi-Wall® system allows for post-frame construction on traditional concrete foundations. ICC-ES certified Sturdi-Wall® Plus anchor brackets are constructed of 100% American-made 1/4" steel, robotically welded, and finished with a tough powder coat. Provides the highest ultimate strength connection to your foundation but requires installation while concrete is still wet.\*



## WET-SET ANCHOR BRACKETS

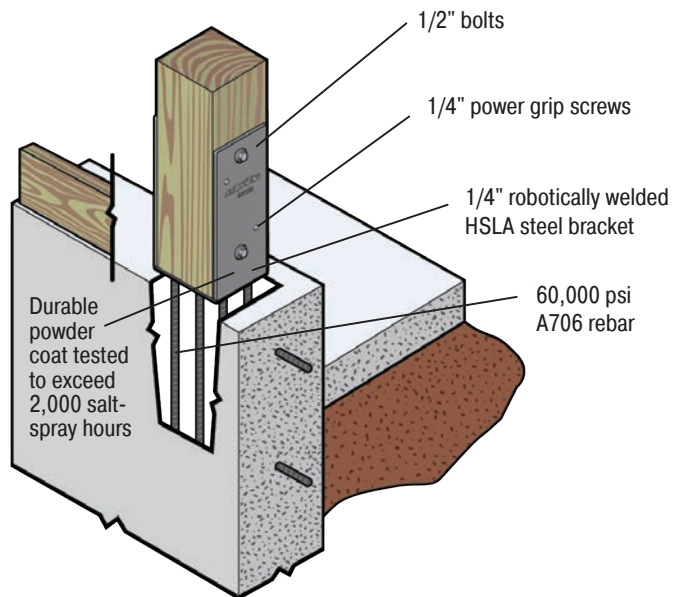

Model ID	Type	Bracket height	Description	Weight (lbs.)
<b>SWP46</b>	4" x 6"	13"	3-5/8" pocket fits 4" x 6" post	16
<b>SWP63</b>	3-Ply 6"	13"	4-5/8" pocket fits 3-Ply 6" laminated column	16
<b>SWP66</b>	6" x 6"	13"	5-5/8" pocket fits 6" x 6" post	17
<b>SWP64</b>	4-Ply 6"	18"	6-1/8" pocket fits 4-Ply 6" laminated column	21
<b>SWP83</b>	3-Ply 8"	18"	4-5/8" pocket fits 3-Ply 8" laminated column	27
<b>SWP84</b>	4-Ply 8"	18"	6-1/8" pocket fits 4-Ply 8" laminated column	28
<b>SWP85</b>	5-Ply 8"	18"	7-5/8" pocket fits 5-Ply 8" laminated column or 8" x 8" post	29
<b>SWP88</b>	8" x 8"	18"	8-1/8" pocket fits 8" x 8" architectural post	30

\*Hardware sold separately.



**STURDI-WALL®**  
BY PERMA-COLUMN

## STURDI-WALL® PLUS ANCHOR BRACKETS

The Sturdi-Wall® system allows for post-frame construction on traditional concrete foundations. ICC-ES certified Sturdi-Wall® Plus anchor brackets are constructed of 100% American-made 1/4" steel, robotically welded, and finished with a tough powder coat. Provides the highest ultimate strength connection to your foundation but requires installation while concrete is still wet.\*



Model ID	Type	Bracket height	Description	Weight (lbs.)
<b>SWP63GL</b>	3-Ply 6"	13"	4-3/16" pocket fits 3-Ply 6" laminated column	16
<b>SWP64GL</b>	4-Ply 6"	18"	5-9/16" pocket fits 4-Ply 6" laminated column	21
<b>SWP83GL</b>	3-Ply 8"	18"	4-3/16" pocket fits 3-Ply 8" laminated column	27
<b>SWP84GL</b>	4-Ply 8"	18"	5-9/16" pocket fits 4-Ply 8" laminated column	28
<b>SWP85GL</b>	5-Ply 8"	18"	6-15/16" pocket fits 5-Ply 8" laminated column or 8" x 8" post	29

\*Hardware sold separately.

### WET-SET ANCHOR BRACKETS

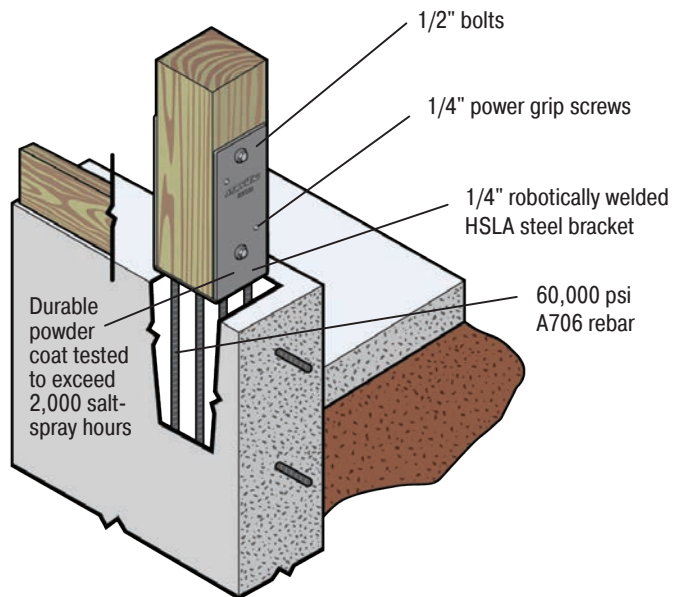

**STURDI-WALL®**  
BY PERMA-COLUMN

## HARDWARE

Get all the hardware and accessories you need to assemble Perma-Column® products. We sell hardware individually or in kits. See our hardware specifications below.



### SOLD SEPARATELY

Model ID	Size	Description
<b>HW10</b>	5/8" x 6"	Wedge anchor, screw type, zinc-plated. Install anchor with 5/8" masonry drill bit. Drill hole 5/8" deeper than anchor. Tighten to 75 ft.-lbs.
<b>HW45</b>	1/4" x 3"	Grade 5 galvanized power grip screw
<b>HW28</b>	3/16" x 2-1/2"	Galvanized nails. Connect a building's lower splash board to the concrete Perma-Column®. Start by drilling a 3/16" hole through the splash board into the concrete post 1-1/4" deep using a hammer drill. Stay 1-3/4" away from the edge of the post. Finally, secure splash board by hammering concrete nail like a typical nail.

### UNIVERSAL DRILL SET HARDWARE

Model ID	Item	Description
<b>HW60DS</b>	6" universal	6" universal drill set hardware. Drill set hardware for 6" column at corner and door jamb includes: <ul style="list-style-type: none"> <li>• (2) 1/2" x 7" zinc-plated Grade 5 carriage bolts, washers, and nuts</li> <li>• (2) 1/4" x 3" Grade 5 galvanized power grip screw (Item HW45)</li> <li>• (1) 5/8" x 6" wedge anchor, screw type, zinc-plated (Item HW10)</li> </ul>
<b>HW80DS</b>	8" universal	8" universal drill set hardware. Drill set hardware for 8" column at corner and door jamb includes: <ul style="list-style-type: none"> <li>• (2) 1/2" x 9" zinc-plated Grade 5 carriage bolts, washers, and nuts</li> <li>• (4) 1/4" x 3" Grade 5 galvanized power grip screw (Item HW45)</li> <li>• (1) 5/8" x 6" wedge anchor, screw type, zinc-plated (Item HW10)</li> </ul>

### SKIRT BOARD HARDWARE

Item #	Description	Weight (lbs.)	Box Qty (count)
<b>PC15SB</b>	G185 galvanized skirt board bracket	0.5	100
<b>HW26</b>	3/16" x 1-1/8" galvanized concrete nail	0.013	1000

## HARDWARE KITS

Hardware kits are to be used for Perma-Column® and Sturdi-Wall® Plus products. They are available in a variety of options. See specifications below.



### PERMA-COLUMN® AND STURDI-WALL® PLUS HARDWARE

Model ID	Item	Description
<b>HW46</b>	4" x 6" kit	Wood-to-bracket connection hardware for 4" x 6" post includes: • (2) 1/2" x 5" zinc-plated Grade 5 bolts, washers, and nuts • (4) 1/4" x 3" Grade 5 galvanized power grip screw (Item HW45)
<b>HW63</b>	3-Ply 6" kit	Wood-to-bracket connection hardware for 3-Ply 6" laminated column includes: • (2) 1/2" x 6" zinc-plated Grade 5 bolts, washers, and nuts • (4) 1/4" x 3" Grade 5 galvanized power grip screw (Item HW45)
<b>HW66</b>	6" x 6" kit	Wood-to-bracket connection hardware for 6" x 6" post includes: • (2) 1/2" x 7" zinc-plated Grade 5 bolts, washers, and nuts • (4) 1/4" x 3" Grade 5 galvanized power grip screw (Item HW45)
<b>HW64</b>	4-Ply 6" kit	Wood-to-bracket connection hardware for 4-Ply 6" laminated column includes: • (2) 1/2" x 7-1/2" zinc-plated Grade 5 bolts, washers, and nuts • (4) 1/4" x 3" Grade 5 galvanized power grip screw (Item HW45)
<b>HW83</b>	3-Ply 8" kit	Wood-to-bracket connection hardware for 3-Ply 8" laminated column includes: • (2) 1/2" x 6" zinc-plated Grade 5 bolts, washers, and nuts • (8) 1/4" x 3" Grade 5 galvanized power grip screw (Item HW45)
<b>HW84</b>	4-Ply 8" kit	Wood-to-bracket connection hardware for 4-Ply 8" laminated column includes: • (2) 1/2" x 7-1/2" zinc-plated Grade 5 bolts, washers, and nuts • (8) 1/4" x 3" Grade 5 galvanized power grip screw (Item HW45)
<b>HW85</b>	5-Ply 8" kit	Wood-to-bracket connection hardware for 5-Ply 8" laminated column includes: • (2) 1/2" x 9" zinc-plated Grade 5 bolts, washers, and nuts • (8) 1/4" x 3" Grade 5 galvanized power grip screw (Item HW45)
<b>HW88</b>	8" x 8" kit	Wood-to-bracket connection hardware for 8" x 8" post includes: • (2) 1/2" x 9-1/2" zinc-plated Grade 5 bolts, washers, and nuts • (8) 1/4" x 3" Grade 5 galvanized power grip screw (Item HW45)



## DRILL SET HARDWARE KITS

Drill set hardware kits are available in a variety of options. See specifications below.



### STURDI-WALL® HARDWARE

Model ID	Item	Description
<b>HW46DS</b>	4" x 6" drill set kit	Wood-to-bracket connection hardware for 4" x 6" post includes: • (2) 1/2" x 5" zinc-plated Grade 5 bolts, washers, and nuts • (4) 1/4" x 3" Grade 5 galvanized power grip screw (Item HW45) • (2) 5/8" x 6" wedge anchor, screw type, zinc-plated (Item HW10)
<b>HW63DS</b>	3-Ply 6" drill set kit	Drill set hardware for 3-Ply 6" laminated column includes: • (2) 1/2" x 6" zinc-plated Grade 5 bolts, washers, and nuts • (4) 1/4" x 3" Grade 5 galvanized power grip screw (Item HW45) • (2) 5/8" x 6" wedge anchor, screw type, zinc-plated (Item HW10)
<b>HW66DS</b>	6" x 6" drill set kit	Drill set hardware for 6" x 6" post includes: • (2) 1/2" x 7" zinc-plated Grade 5 bolts, washers, and nuts • (4) 1/4" x 3" Grade 5 galvanized power grip screw (Item HW45) • (2) 5/8" x 6" wedge anchor, screw type, zinc-plated (Item HW10)
<b>HW64DS</b>	4-Ply 6" drill set kit	Drill set hardware for 4-Ply 6" laminated column includes: • (2) 1/2" x 7-1/2" zinc-plated Grade 5 bolts, washers, and nuts • (4) 1/4" x 3" Grade 5 galvanized power grip screw (Item HW45) • (2) 5/8" x 6" wedge anchor, screw type, zinc-plated (Item HW10)
<b>HW83DS</b>	3-Ply 8" drill set kit	Drill set hardware for 3-Ply 8" laminated column includes: • (2) 1/2" x 6" zinc-plated Grade 5 bolts, washers, and nuts • (8) 1/4" x 3" Grade 5 galvanized power grip screw (Item HW45) • (2) 5/8" x 6" wedge anchor, screw type, zinc-plated (Item HW10)
<b>HW84DS</b>	4-Ply 8" drill set kit	Drill set hardware for 4-Ply 8" laminated column includes: • (2) 1/2" x 7-1/2" zinc-plated Grade 5 bolts, washers, and nuts • (8) 1/4" x 3" Grade 5 galvanized power grip screw (Item HW45) • (2) 5/8" x 6" wedge anchor, screw type, zinc-plated (Item HW10)
<b>HW85DS</b>	5-Ply 8" drill set kit	Drill set hardware for 5-Ply 8" laminated column includes: • (2) 1/2" x 9" zinc-plated Grade 5 bolts, washers, and nuts • (8) 1/4" x 3" Grade 5 galvanized power grip screw (Item HW45) • (2) 5/8" x 6" wedge anchor, screw type, zinc-plated (Item HW10)
<b>HW88DS</b>	8" x 8" drill set kit	Drill set hardware for 8" x 8" post includes: • (2) 1/2" x 9-1/2" zinc-plated Grade 5 bolts, washers, and nuts • (8) 1/4" x 3" Grade 5 galvanized power grip screw (Item HW45) • (2) 5/8" x 6" wedge anchor, screw type, zinc-plated (Item HW10)

# UPLIFT ANCHOR KITS

Uplift anchors are bolted to the existing precast pipe at the base of a Perma-Column®. The stated uplift protection is approximated for when the anchors are properly installed and backfilled with dirt.



## UPLIFT ANCHOR KIT FOR PERMA-COLUMN® 6" SERIES

Model ID	Size	Description
<b>UA61</b>	8-1/2"	Kit includes: • (2) 2" x 2" x 8-1/2" galvanized angles • (1) 1/2" x 6" galvanized Grade 5 bolt, nut, and washer
<b>UA62</b>	12"	Kit includes: • (2) 2" x 2" x 12" galvanized angles • (1) 1/2" x 6" galvanized Grade 5 bolt, nut, and washer

## UPLIFT ANCHOR KIT FOR PERMA-COLUMN® 8" SERIES

Model ID	Size	Description
<b>UA81</b>	8-1/2"	Kit includes: • (2) 2" x 2" x 8-1/2" galvanized angles • (1) 1/2" x 8" galvanized Grade 5 bolt, nut, and washer
<b>UA82</b>	12"	Kit includes: • (2) 2" x 2" x 12" galvanized angles • (1) 1/2" x 8" galvanized Grade 5 bolt, nut, and washer

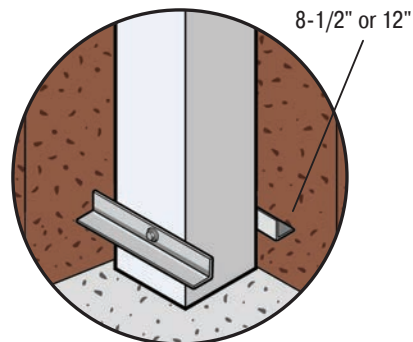

## COLUMN EXTENDERS

Perma-Column® column extenders provide deeper post embedment. All kits include bolt, nut, and washer to connect with Perma-Column®.

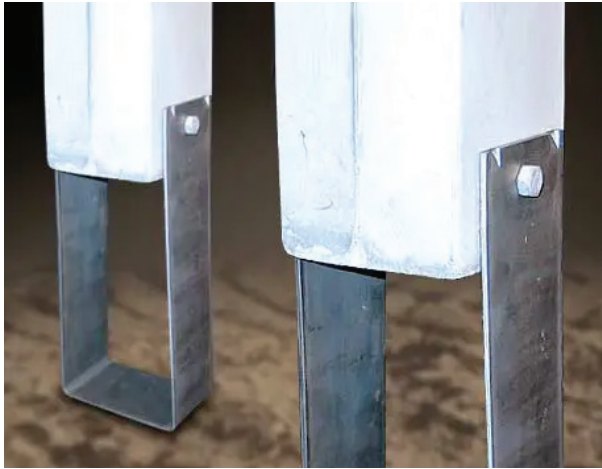

### COLUMN EXTENDER FOR PERMA-COLUMN® 6" SERIES

Model ID	Size	Description
<b>CE61</b>	12"	12" column extender for 6" Perma-Column® provides deeper post embedment. Kit includes 7" bolt, nut, and washer to connect with Perma-Column®.
<b>CE62</b>	24"	24" column extender for 6" Perma-Column® provides deeper post embedment. Kit includes 7" bolt, nut, and washer to connect with Perma-Column®.

### COLUMN EXTENDER FOR PERMA-COLUMN® 8" SERIES

Model ID	Size	Description
<b>CE81</b>	12"	12" column extender for 8" Perma-Column® provides deeper post embedment. Kit includes 9" bolt, nut, and washer to connect with Perma-Column®.
<b>CE82</b>	24"	24" column extender for 8" Perma-Column® provides deeper post embedment. Kit includes 9" bolt, nut, and washer to connect with Perma-Column®.

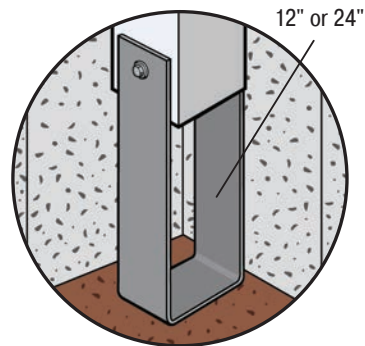

BUILD BETTER. BUILD STRONGER. BUILD TO LAST.



400 Carol Ann Lane, Ossian, IN 46777 | Tel: 800 622-7190 | Fax: 260 622-7192

[permacolumn.com](http://permacolumn.com)